

# DL2700 Series



Electronic battery operated digital lock. Holds up to 17 user codes (1 master, 1 management & 15 users).

**Specifications:**

- Door Thickness:** Fits 1<sup>5</sup>/<sub>8</sub>" to 1<sup>7</sup>/<sub>8</sub>"
- Backset:** 2<sup>3</sup>/<sub>4</sub>"
- Strike:** 1<sup>1</sup>/<sub>8</sub>" x 2<sup>3</sup>/<sub>4</sub>" T strike & 1<sup>1</sup>/<sub>4</sub>" x 4<sup>7</sup>/<sub>8</sub>" ASA strike included
- Latchbolt:** UL Listed; fire rated 3 hours, 1/2" throw reversible
- Handing:** Non-handed
- Power:** Five AA alkaline batteries (included)
- Keypad:** All metal, 12 button. All functions programmed through keypad
- Door prep:** Standard ANSI A115 series prep, modified by adding additional through-bolt holes
- Compliances:** Grade 1 heavy duty cylindrical lockset. UL listed to the 10C positive pressure specification. FCC certified. ADA compliant levers.
- Cylinder:** Six pin solid brass, SC1 keyway, furnished with all key override locks. Schlage, Corbin-Russwin CL, Sargent 480 series, ASSA 65-611 & Lori cylinders can also be used with HW620 tailpiece (supplied).
- Interchangeable Core Models:** Standard model accepts six and seven pin cylinders from Best, Corbin-Russwin and Schlage.

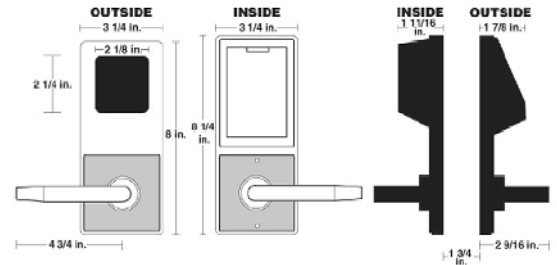

PRODUCT	FINISH
<b>DL2700</b> Standard key override	<b>26D</b>



**Serving North America**

**Pennsylvania**  
800-233-4210  
Fax: 800-854-4146

**Missouri**  
800-211-4607  
Fax: 800-211-4608

**Nevada**  
800-722-4210  
Fax: 800-248-3620

**Texas**  
866-693-6903  
Fax: 866-693-6904

[www.topnotch.bz](http://www.topnotch.bz) • [sales@topnotch.bz](mailto:sales@topnotch.bz)

# Notes

---



---

## Serving North America

**Pennsylvania**  
800-233-4210  
Fax: 800-854-4146

**Missouri**  
800-211-4607  
Fax: 800-211-4608

**Nevada**  
800-722-4210  
Fax: 800-248-3620

**Texas**  
866-693-6903  
Fax: 866-693-6904

[www.topnotch.bz](http://www.topnotch.bz) • [sales@topnotch.bz](mailto:sales@topnotch.bz)